

Weatherproof FS Boxes

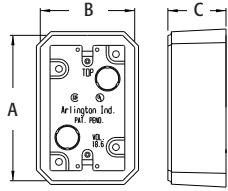

18.6 cu. in.

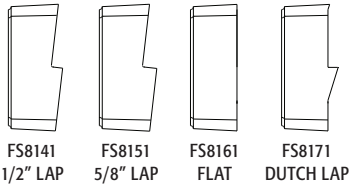

One-piece construction electrical box provides a clean, weatherproof, UL Listed installation. Deep design for GFCIs. Paintable, UV rated plastic for long outdoor life.

FEATURES AND BENEFITS

- Provides a solid, attractive, UL listed installation
- Accommodates GFCI, switches, and outlets
- For use with all siding types... 1/2", 5/8", Dutch Lap, and flat surfaces

| CATALOG NUMBER | UPC/DCI/NAED MFG #018997 | SIDING TYPE/STYLE | UNIT PKG | STD PKG | DIM A | DIM B | DIM C |
|----------------|--------------------------|-------------------|----------|---------|-------|-------|-------|
| FS8141 | 17340 | 1/2" Lap | 25 | 25 | 5.093 | 3.312 | 2.558 |
| FS8151 | 17341 | 5/8" Lap | 25 | 25 | 5.093 | 3.312 | 2.697 |
| FS8161 | 17342 | Flat Surfaces | 25 | 25 | 5.093 | 3.312 | 2.174 |
| FS8171 | 17343 | Dutch Lap | 25 | 25 | 5.093 | 3.312 | 2.536 |

Add suffix "GC" to Catalog # when ordering in Canada to include grounding clip, for example FS8141GC.

PATENTED.



INSTALLATION INSTRUCTIONS



Remove KO from FS Box & insert NM cable connector. Push cable through connector & position box onto siding.



Mount box to siding and install your choice of either a GFCI, switch or duplex receptacle.

Complete installation with one of Arlington's code required extra-duty weatherproof while-in-use 60 Series or 61 Series Low Profile IN-AND-OUT™ covers. **See Page K-16 for more information.**